

**Wandsworth Civic Suite**  
**Function Layout Plan**

**Name:**  
**Function Date:**

Seating Capacities

**Civic Hall: 295 (includes head table for 15)**

**Banquet Hall: 210 (Buffet), 240 (Table Service)**

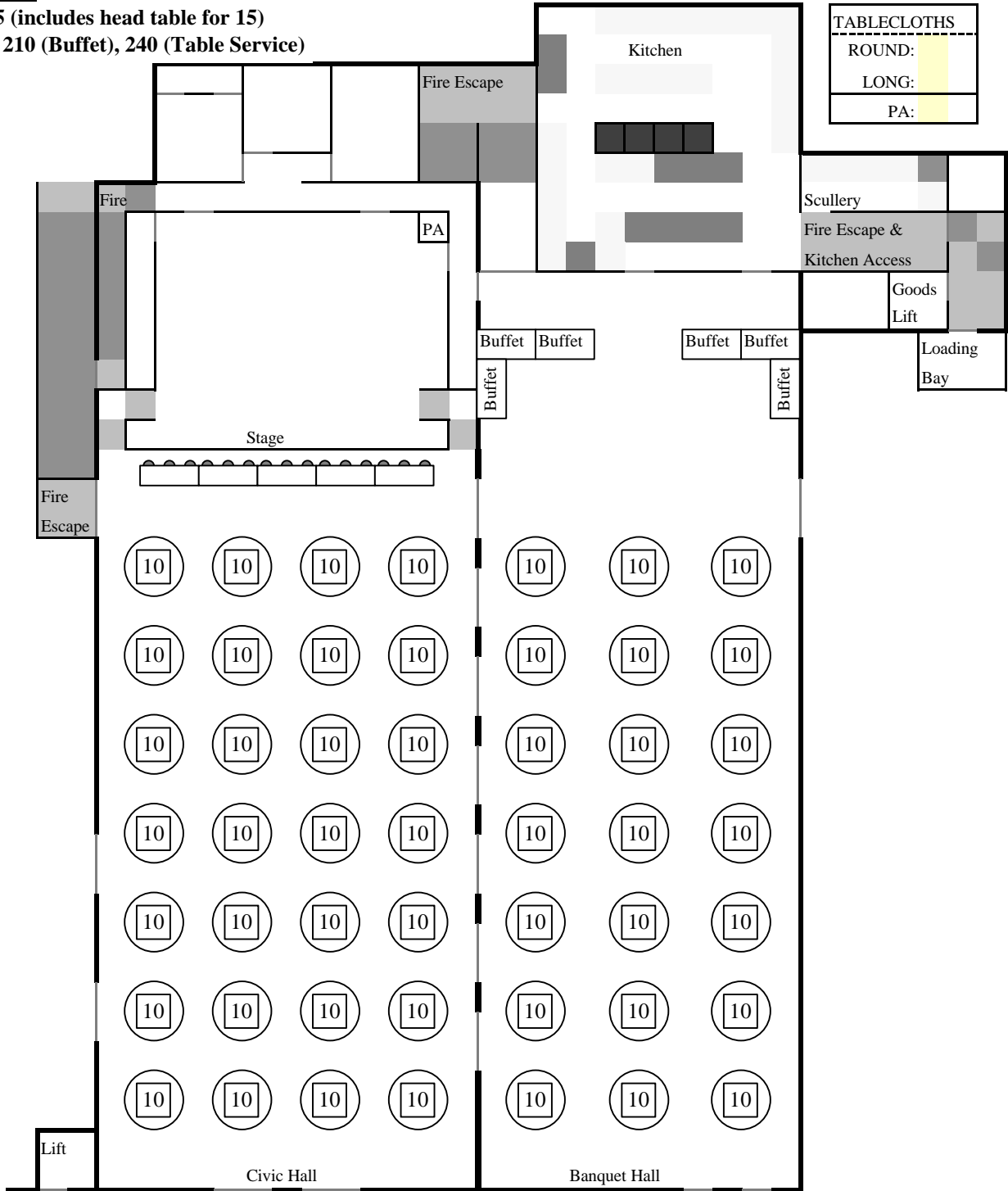

TABLECLOTHS	
ROUND:	
LONG:	
PA:	

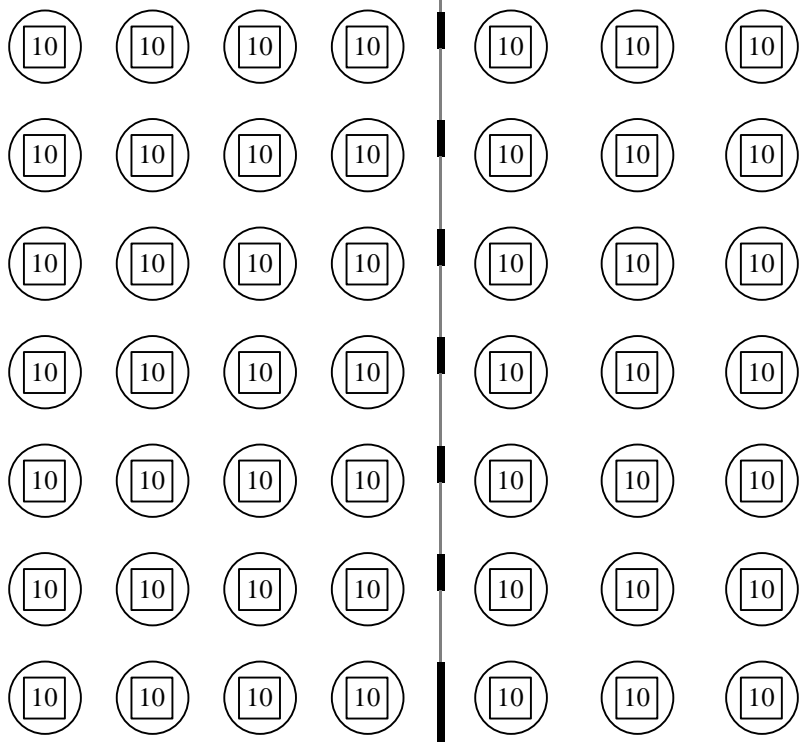

**Kitchen - Key**

	2 x Steam/Convection Ovens
	4 x Hobs / 2 x Standard Ovens
	1 x Fryer
	3 x Warming Ovens
	3 x Fridges
	Half Size Chest Freezer
	Commercial Dishwasher
	Urn (permanent boiling water)
	4 x Sinks
	Work Surface
	Bain Marie

**Dimensions**

<b>Civic Hall:</b>	<b>Banqueting Hall:</b>
Length 75ft (23m)	Length 88ft (27m)
Width 43ft (13m)	Width 33ft (10m)
Ceiling height 18ft (5.5m)	Stage Units:
Stage 28ft x 24ft (9m x 7m)	8 Units - 8ft 4ft

**Wandsworth Civic Suite**  
**Function Layout Plan**

**Name:**  
**Function Date:**

**Seating Capacities**

**Civic Hall: 220**

**Banquet Hall: 210 (Buffet), 240 (Table Service)**

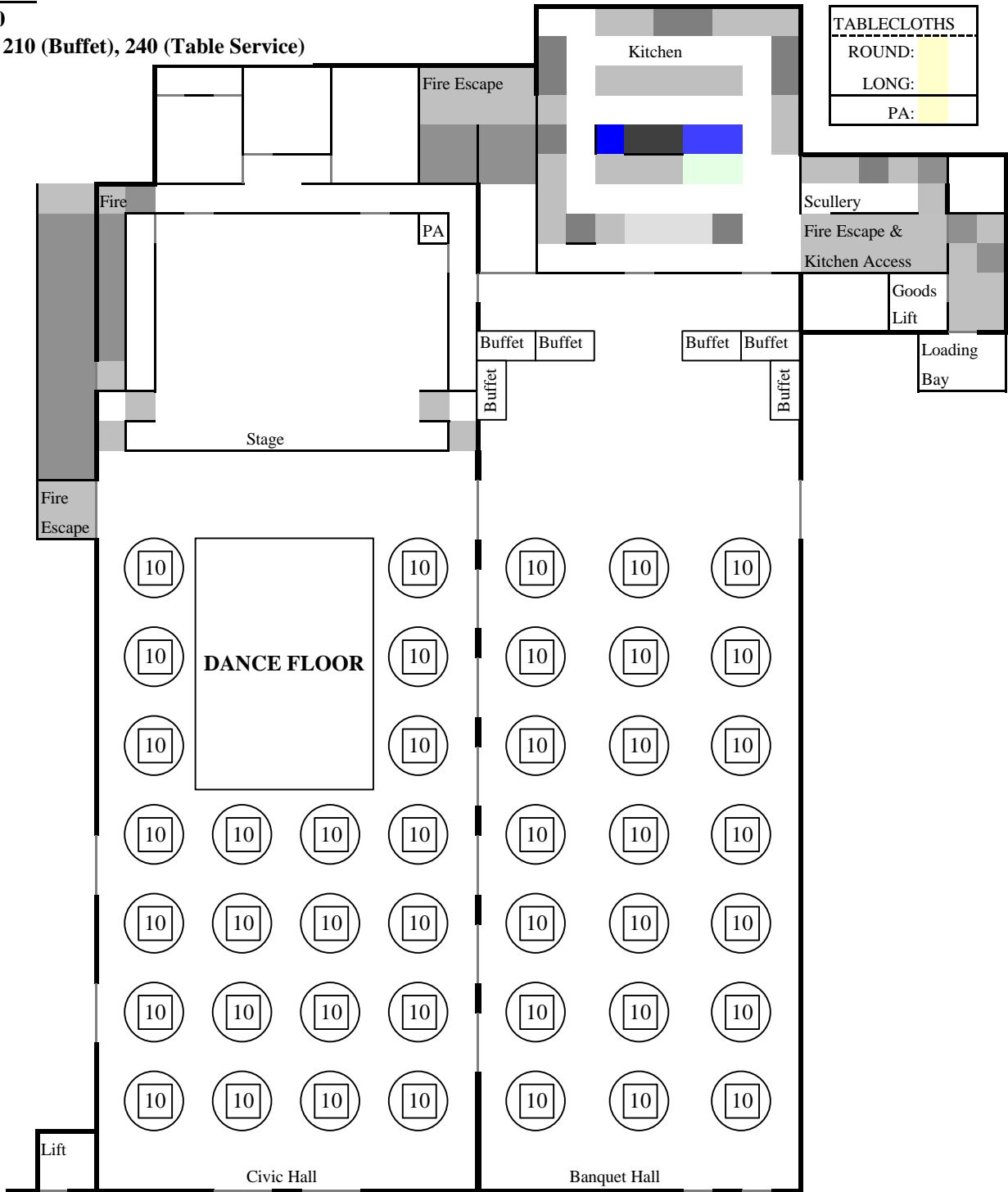

TABLECLOTHS	
ROUND:	
LONG:	
PA:	

**Kitchen - Key**

	2 x Steam/Convection Ovens
	4 x Hobs / 2 x Standard Ovens
	1 x Fryer
	3 x Warming Ovens
	3 x Fridges
	Half Size Chest Freezer
	Commercial Dishwasher
	Urn (permanent boiling water)
	4 x Sinks
	Work Surface
	Bain Marie

**Dimensions**

<b>Civic Hall:</b>	<b>Banqueting Hall:</b>
<i>Length 75ft (23m)</i>	<i>Length 88ft (27m)</i>
<i>Width 43ft (13m)</i>	<i>Width 33ft (10m)</i>
<i>Ceiling height 18ft (5.5m)</i>	<b>Stage Units:</b>
<i>Stage 28ft x 24ft (9m x 7m)</i>	<b>8 Units - 8ft 4ft</b>

**Wandsworth Civic Suite**  
**Function Layout Plan**

**Name:**  
**Function Date:**

**Seating Capacities**  
**Civic Hall: 436**  
**Banquet Hall: 210**

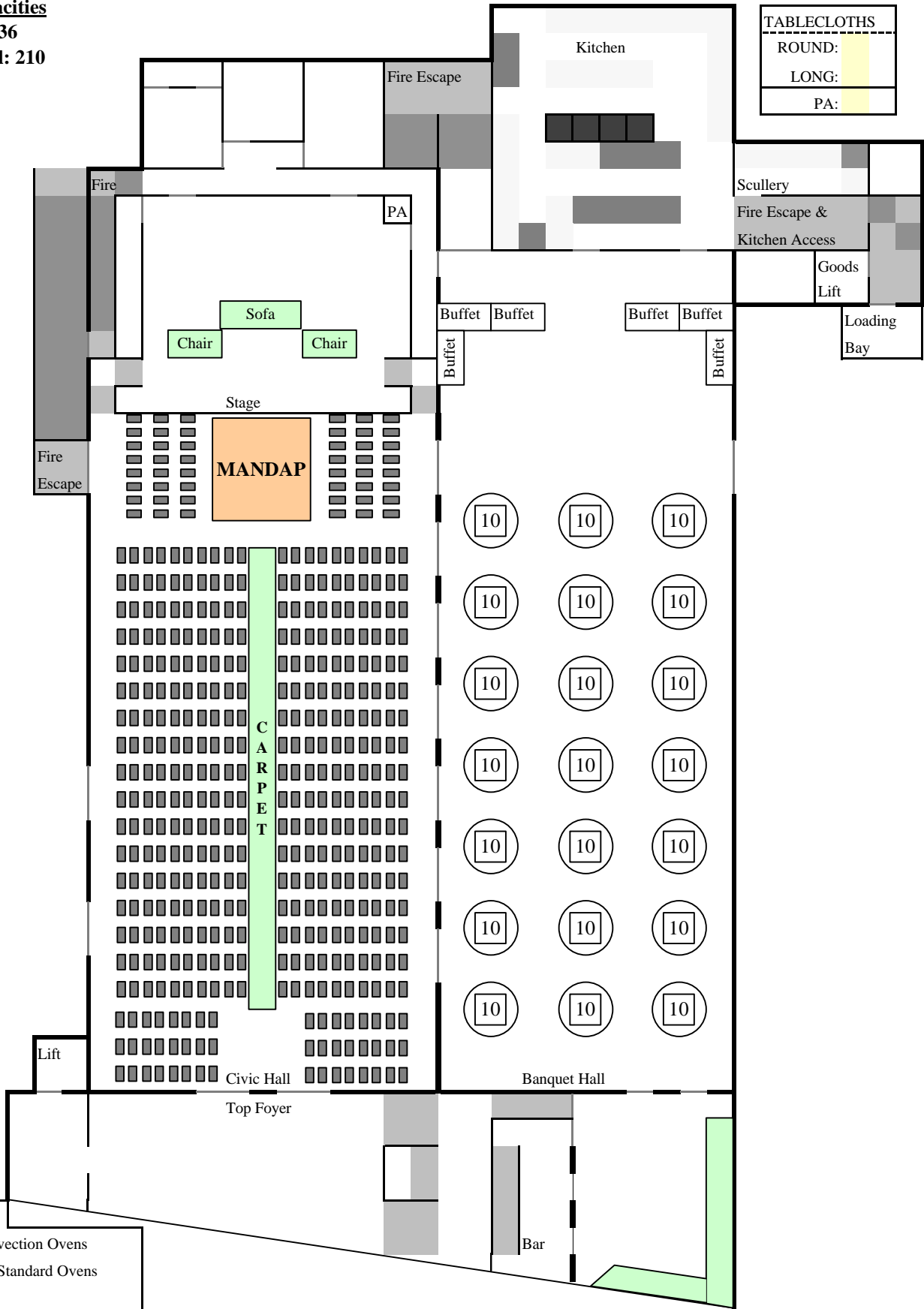

TABLECLOTHS	
ROUND:	
LONG:	
PA:	

**Kitchen - Key**

	2 x Steam/Convection Ovens
	4 x Hobs / 2 x Standard Ovens
	1 x Fryer
	3 x Warming Ovens
	3 x Fridges
	Half Size Chest Freezer
	Commercial Dishwasher
	Urn (permanent boiling water)
	4 x Sinks
	Work Surface
	Bain Marie

**Dimensions**

<b>Civic Hall:</b>	<b>Banqueting Hall:</b>
Length 75ft (23m)	Length 88ft (27m)
Width 43ft (13m)	Width 33ft (10m)
Ceiling height 18ft (5.5m)	Stage Units:
Stage 28ft x 24ft (9m x 7m)	8 Units - 8ft 4ft

**Wandsworth Civic Suite**  
**Function Layout Plan**

**Name:**  
**Function Date:**

Seating Capacities

**Civic Hall: 240**

**Banquet Hall: 210**

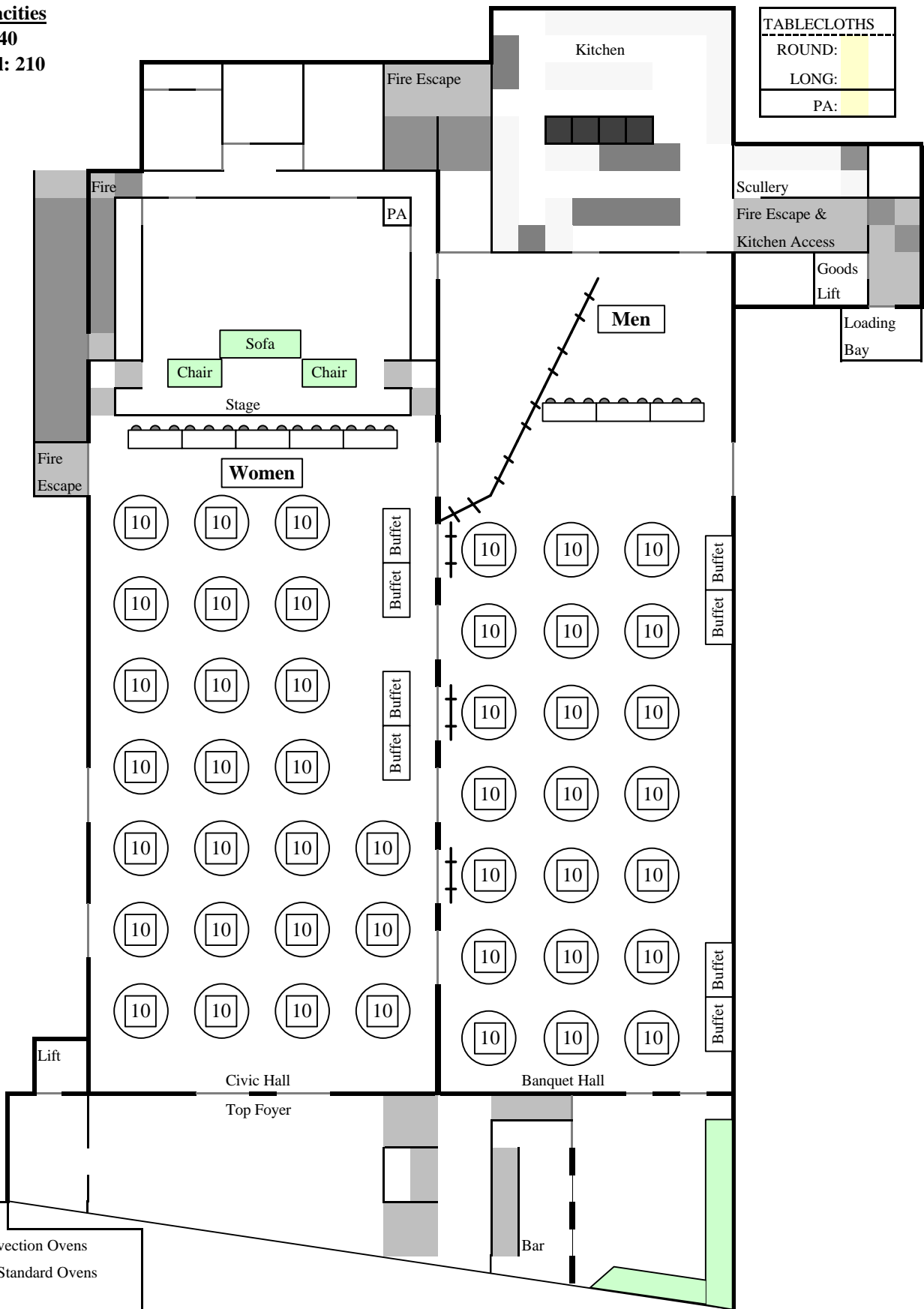

TABLECLOTHS	
ROUND:	
LONG:	
PA:	

**Kitchen - Key**

- 2 x Steam/Convection Ovens
- 4 x Hobs / 2 x Standard Ovens
- 1 x Fryer
- 3 x Warming Ovens
- 3 x Fridges
- Half Size Chest Freezer
- Commercial Dishwasher
- Urn (permanent boiling water)
- 4 x Sinks
- Work Surface
- Bain Marie

**Dimensions**

<b>Civic Hall:</b>	<b>Banqueting Hall:</b>
Length 75ft (23m)	Length 88ft (27m)
Width 43ft (13m)	Width 33ft (10m)
Ceiling height 18ft (5.5m)	Stage Units:
Stage 28ft x 24ft (9m x 7m)	8 Units - 8ft 4ft